

Luminette® Privacy Sheers Standard Side Stack

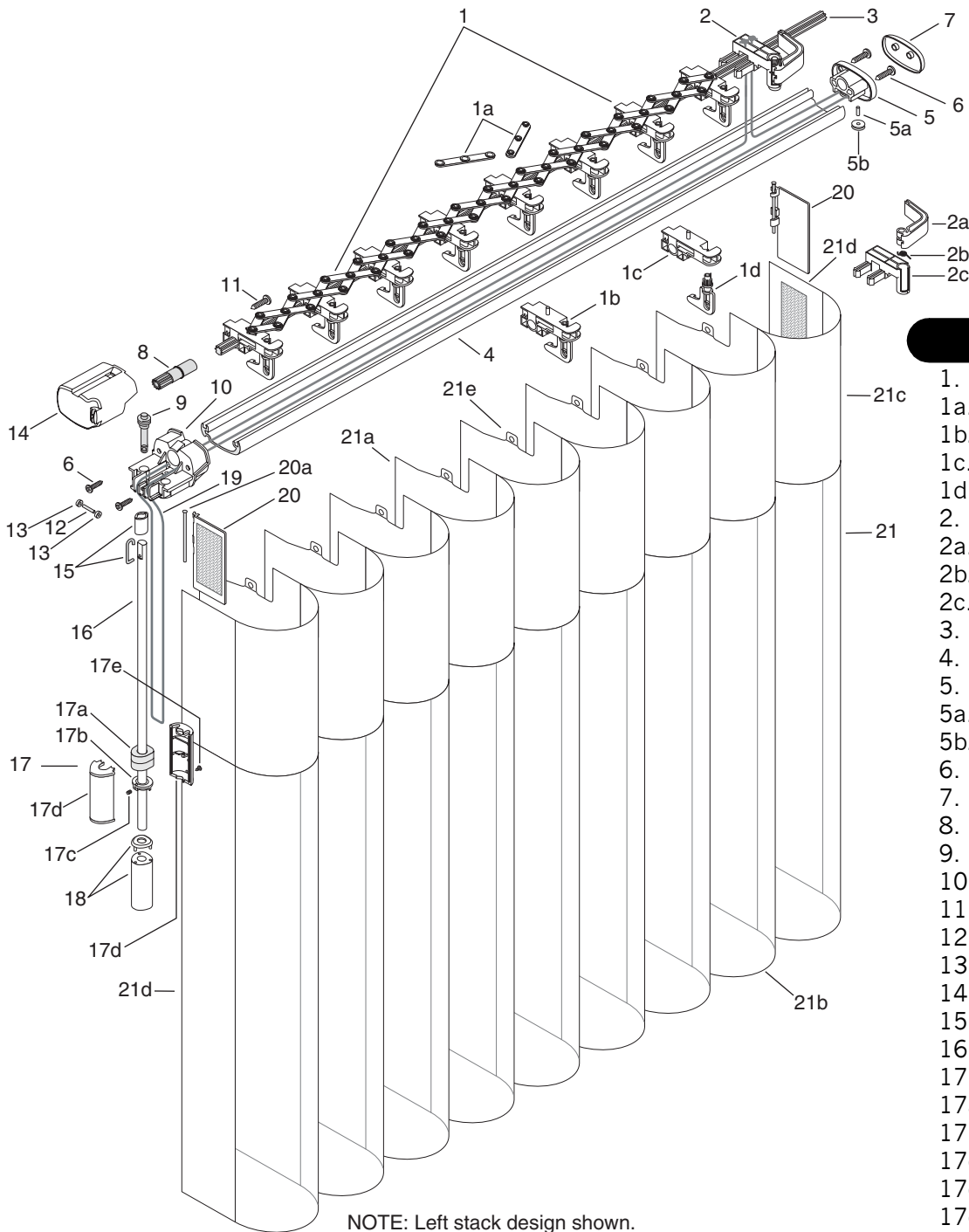

NOTE: Left stack design shown.
Fabric stacks on the wand side of the sheer.

Standard Parts

1. Fabric Carrier Group Assembly
- 1a. Scissors
- 1b. Carrier Body Assembly
- 1c. Carrier Body
- 1d. Tilt Reduction Pinion Clip
2. Lead Carrier Assembly
- 2a. Lead Carrier Swivel Arm
- 2b. Lead Carrier Swivel Arm Spring
- 2c. Lead Carrier
3. Tilt Rod Extrusion
4. Headrail
5. Passive End Cap Assembly
- 5a. SS Dowel Pin
- 5b. End Cap Wheel
6. Square Pan Head Screw
7. Passive End Cap Cover
8. Tilt Drive Gear
9. Tilt Drive Worm Gear
10. Universal Bulkhead Body
11. Square Head Hi-Lo Screw
12. Active SS Dowel Pin
13. Cord Pulley
14. Universal Bulkhead Cover
15. Wand Hook with Hook Cover
16. Wand
17. Weighted Tether Control
- 17a. Cord Tether Weight Assembly
- 17b. Cord Tether Locking Ring
- 17c. Cord Tether Set Screw
- 17d. Cord Tether Cover
- 17e. Screw
18. Wand Handle & Cover
19. Cord
20. End Treatment Swivel Plate Assembly
- 20a. Rivet (Double-flared)
21. Fabric
- 21a. Fabric Vane
- 21b. Fabric Face
- 21c. Fabric Valance
- 21d. Fabric End Treatment
- 21e. Polytab

Luminette® Privacy Sheers Standard Side Stack

No.	PCN	Description	No.	PCN	Description
1.	4250355000	Fabric Carrier Group Assembly with Tilt Reduction Pinion Clip	16.	4250090000	Wand 21" Standard
1a.	4250076000	Scissors (Male and Female)		4250092000	Wand 38" Standard
1b.	N/A	Carrier Body Assembly		4250093000	Wand 48" Standard
1c.	N/A	Carrier Body		4250095000	Wand 68" Standard
1d.	N/A	Tilt Reduction Pinion Clip		4250091000	Wand 28" Non-Standard
2.	4250127xxx	Lead Carrier Assembly RH		4250094000	Wand 58" Non-Standard
	4250128xxx	Lead Carrier Assembly LH		4250096000	Wand 78" Non-Standard
2a.	N/A	Lead Carrier Swivel Arm (RH/LH specific)		4250097000	Wand 88" Non-Standard
				4250098000	Wand 96" Non-Standard
2b.	N/A	Lead Carrier Swivel Arm Spring		4250110000	Wand 120" Non-Standard
2c.	N/A	Lead Carrier (RH/LH specific)		4250111000	Wand 144" Non-Standard
3.	N/A	Aluminum Tilt Rod Extrusion - 12'	17.	4250150xxx	Weighted Tether Control Assembly
	N/A	Brass Tilt Rod Extrusion - 16'	17a.	N/A	Cord Tether Weight
4.	4250010xxx	Headrail - 16'	17b.	N/A	Cord Tether Locking Ring
5.	4250108xxx	Passive End Cap Assembly	17c.	N/A	Cord Tether Set Screw
5a.	N/A	SS Dowel Pin 3/32" x .21"	17d.	N/A	Cord Tether Cover
5b.	N/A	End Cap Wheel	17e.	N/A	Screw 4 x 1/4"
6.	4250212000	#6 x 1/2" Square Pan Head Tapping (End Cap) Screw	18.	4250107xxx	Wand Handle & Cover
7.	4250109xxx	Passive End Cap Cover	19.	4250050000	D26 Cord - White
8.	4250058000	Tilt Drive Gear	20.	4250120xxx	End Treatment Swivel Plate Assembly w/Velcro® RH
9.	4250051000	Tilt Drive Worm Gear		4250121xxx	End Treatment Swivel Plate Assembly w/Velcro® LH
10.	4250011xxx	Universal Bulkhead Body	20a.	N/A	Rivet (1.5" Copper Nickle, Double-flared)
11.	4250146000	Square Head Hi-Lo 6-19 x 3/4" (Stationary Carrier) Screw	21.	N/A	Luminette® Fabric: K1, K2, K3, K5, K6, K7, K8, K9, K12, K13, & K14
12.	4250048000	Active SS Dowel Pin 3/32" x .5"	21a.	N/A	Fabric Vane
13.	4250047000	Cord Pulley	21b.	N/A	Fabric Face
14.	4250012xxx	Universal Bulkhead Cover	21c.	N/A	Fabric Valance
15.	4250062xxx	Wand Hook with Hook Cover	21d.	N/A	Fabric End Treatment
			21e.	N/A	Polytab

Additional Hardware:

(For pictures & specifics, see Luminette® Privacy Sheers Standard Additional Hardware)

4250085xxx	Ceiling Mount Bracket Kit
4250084xxx	Installation Bracket Kit
4250081xxx	Spacer Block (With Bushings)
4250082xxx	Extension Bracket Cover Kit (Includes Extension Brackets)

xxx = 3-digit color code